







PIANO INTERRATO





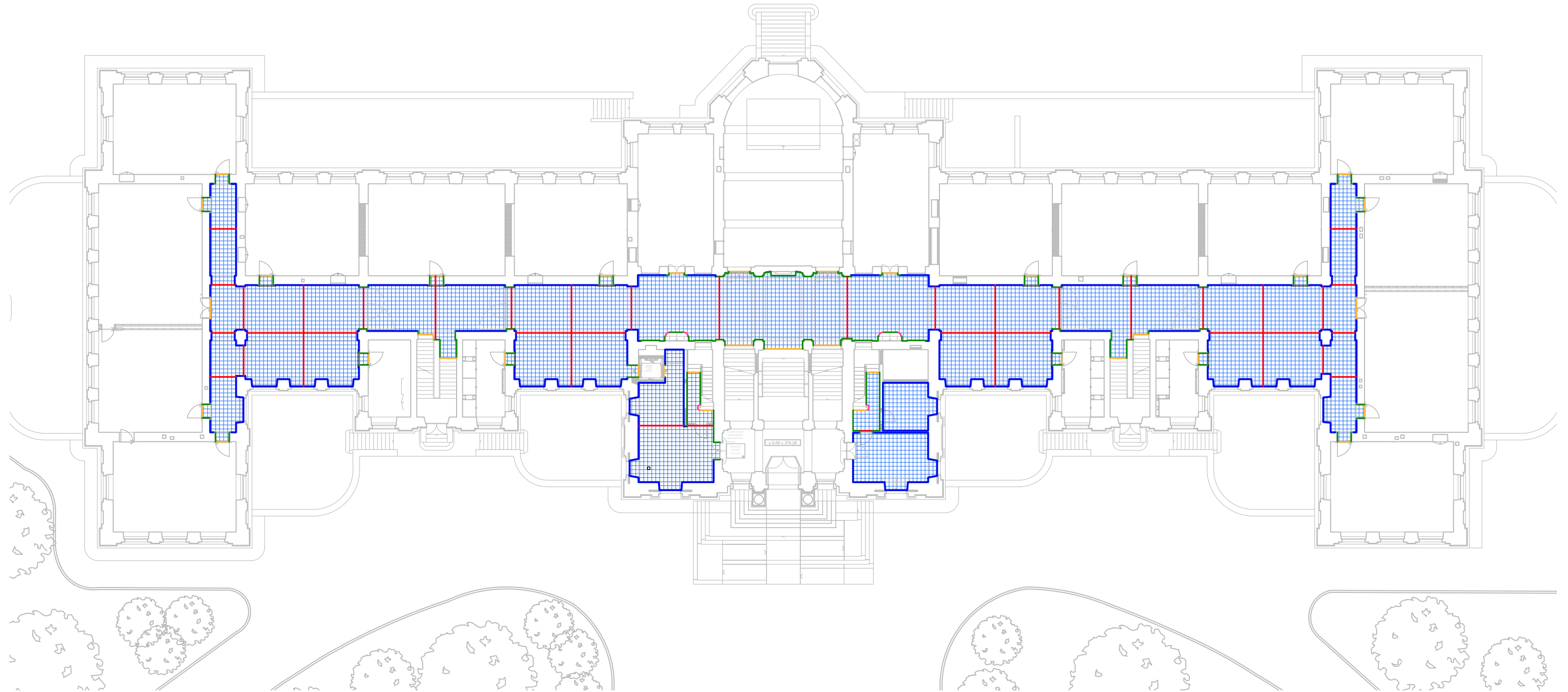

-  G 2.2.1 Pavimenti in piastrelle, 30x30 cm rett., giunti di 2mm
-  G 2.2.10 Battiscopa in piastrelle, 90x15
-  G 2.2.12 Profili in metallo per giunti di movimento
-  G 2.2.12 Profili in metallo
-  tagli in vista
-  tagli in vista curvi



ETHSIAVOTIA <small> PIAZZA MOLINO NUOVO 19 CH-6900 LUGANO T +41 91 922 82 62 F +41 91 922 89 13 info@ethsiazvotia.ch clavicari@ethsiazvotia.ch www.ethsiazvotia.ch </small>	REMO LEUZINGER CLAUDIO VICARI ARCHITETTI 225 PASTLU - RISTRUTTURAZIONE DEGLI SPAZI INTERNI DEL PALAZZO DEGLI STUDI DI LUGANO COMMITTENTE: DECS - DIVISIONE DELLA SCUOLA DFE - SEZIONE DELLA LOGISTICA	DIS: RIA DATA: 14.03.2025 SCALA: 1:300 DIM: 42.0 x 29.7
G 2.2 PAVIMENTI IN PIASTRELLE DI GRANIGLIA PIANTA PIANO INTERRATO		PA 4.7.5.U1



PIANO TERRA





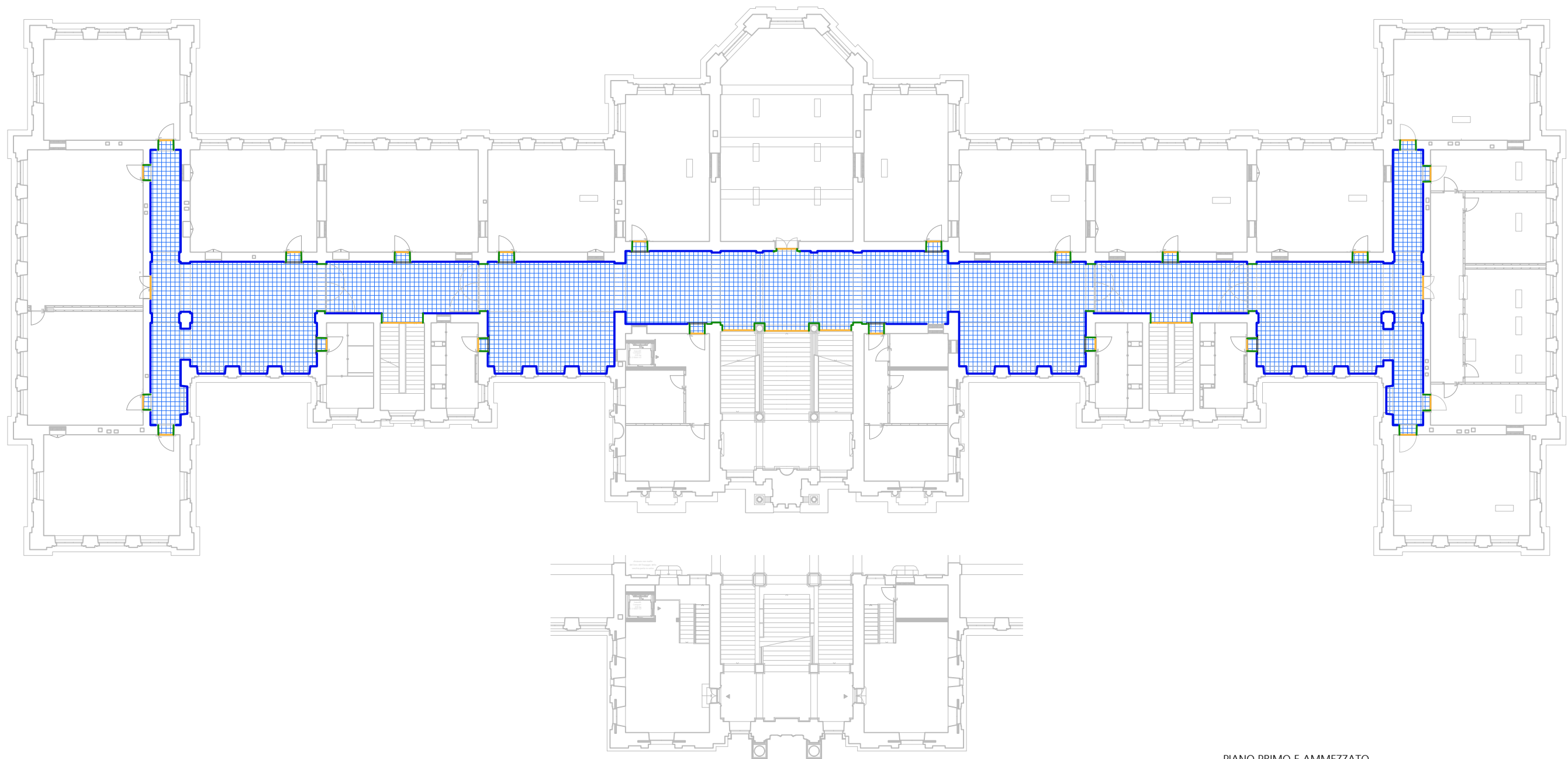

-  G 2.2.1 Pavimenti in piastrelle, 30x30 cm rett., giunti di 2mm
-  G 2.2.10 Battiscopa in piastrelle, 90x15
-  G 2.2.12 Profili in metallo per giunti di movimento
-  G 2.2.12 Profili in metallo
-  tagli in vista
-  tagli in vista curvi



<p>ETHSIAVOTIA PIAZZA MOLINO NUOVO 19 CH-6900 LUGANO T +41 91 922 82 62 F +41 91 922 89 13 info@remoleuzinger.ch claudio@remoleuzinger.ch www.remoleuzinger.ch</p>	<p>REMO LEUZINGER CLAUDIO VICARI ARCHITETTI 225 PASTLU - RISTRUTTURAZIONE DEGLI SPAZI INTERNI DEL PALAZZO DEGLI STUDI DI LUGANO</p> <p>COMMITTENTE: DECS - DIVISIONE DELLA SCUOLA DFE - SEZIONE DELLA LOGISTICA</p>	<p>DIS: RIA DATA: 14.03.2025 SCALA: 1:300 DIM: 42.0 x 29.7</p>
<p>G 2.2 PAVIMENTI IN PIASTRELLE DI GRANIGLIA PIANTE PIANO TERRA</p>		<p>PA 4.7.5.00</p>







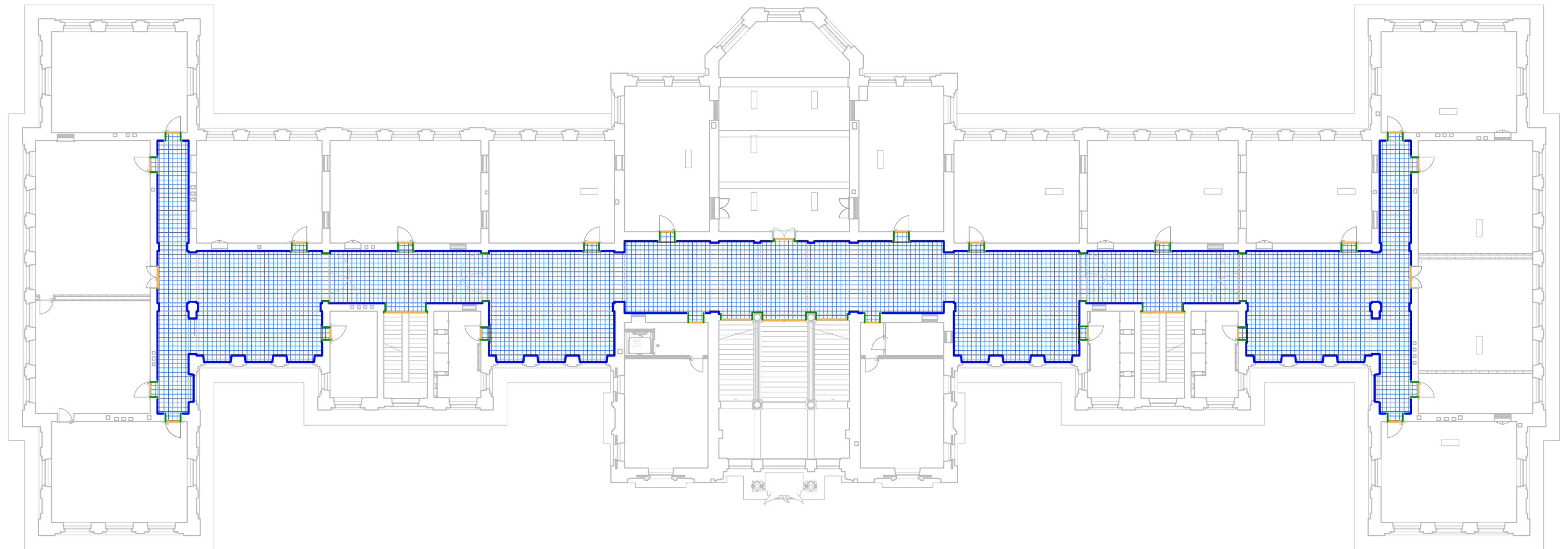

PIANO PRIMO E AMMEZZATO

-  G 2.2.1 Pavimenti in piastrelle, 30x30 cm rett., giunti di 2mm
-  G 2.2.10 Battiscopa in piastrelle, 90x15
-  G 2.2.12 Profili in metallo per giunti di movimento
-  G 2.2.12 Profili in metallo
-  tagli in vista
-  tagli in vista curvi





PIANO SECONDO





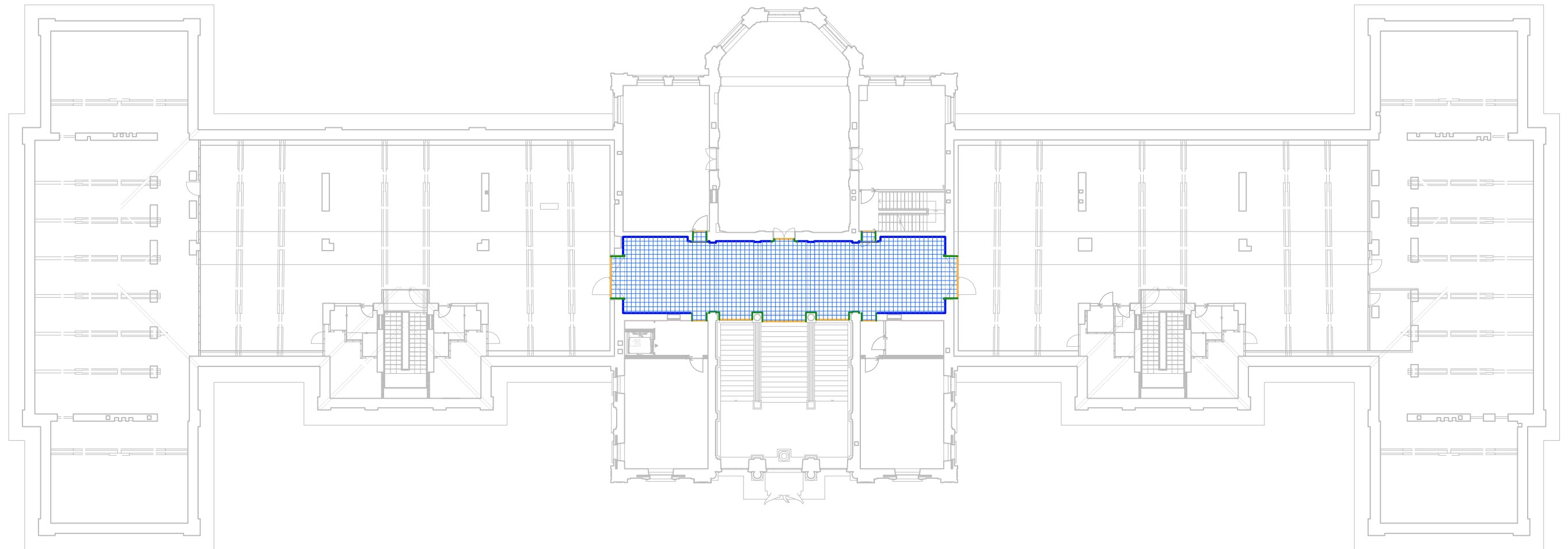

-  G 2.2.1 Pavimenti in piastrelle, 30x30 cm rett., giunti di 2mm
-  G 2.2.10 Battiscopa in piastrelle, 90x15
-  G 2.2.12 Profili in metallo per giunti di movimento
-  G 2.2.12 Profili in metallo
-  tagli in vista
-  tagli in vista curvi



ETHSIAVOTIA	REMO LEUZINGER CLAUDIO VICARI ARCHITETTI	DIS:	RIA
RAZZA MOLINO NUOVO 19 CH-6900 LUGANO T+41 91 922 82 62	225 PASTLU - RISTRUTTURAZIONE DEGLI SPAZI INTERNI DEL PALAZZO DEGLI STUDI DI LUGANO	DATA:	14.03.2025
F+41 91 922 89 13 info@remoleuzinger.ch clavicari@remoleuzinger.ch www.remoleuzinger.ch	COMMITTENTE: DECS - DIVISIONE DELLA SCUOLA DFE - SEZIONE DELLA LOGISTICA	SCALA:	1:300
		DIM:	42.0 x 29.7
	G 2.2 PAVIMENTI IN PIASTRELLE DI GRANIGLIA	PA	4.7.5.02
	PIANTA PIANO SECONDO		



PIANO TERZO

-  G 2.2.1 Pavimenti in piastrelle, 30x30 cm rett., giunti di 2mm
-  G 2.2.10 Battiscopa in piastrelle, 90x15
-  G 2.2.12 Profili in metallo per giunti di movimento
-  G 2.2.12 Profili in metallo
-  tagli in vista
-  tagli in vista curvi



piano interrato

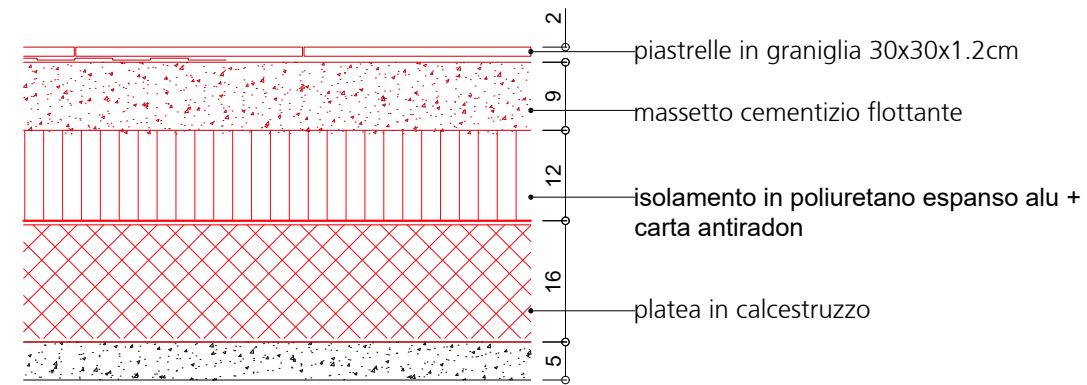

piano terreno

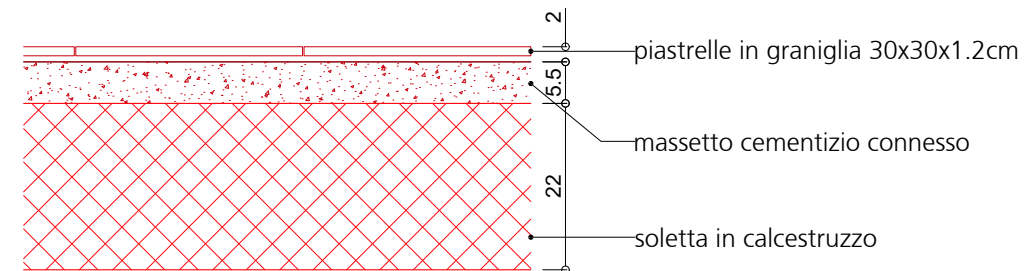

piano primo

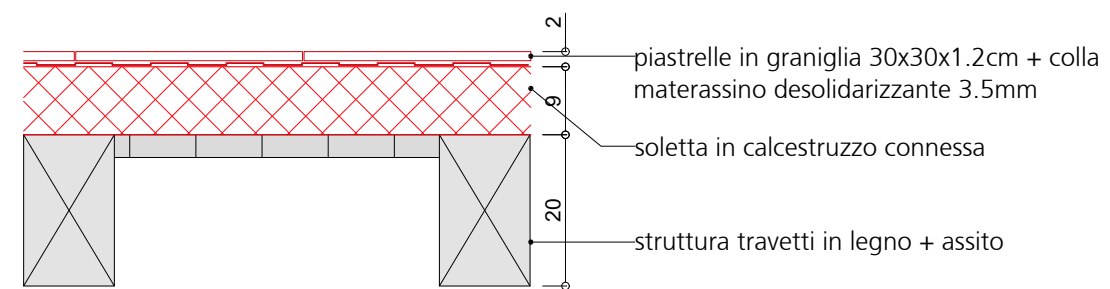



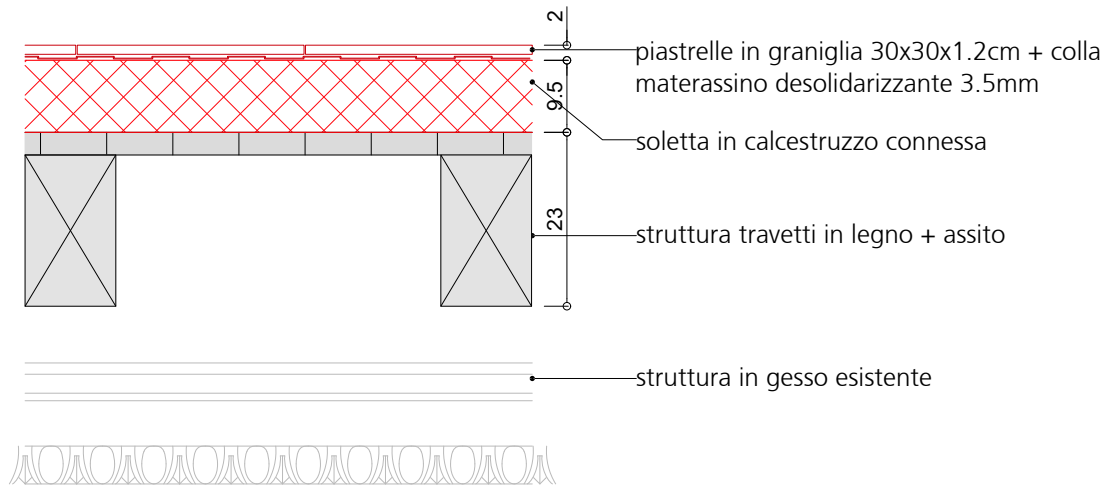

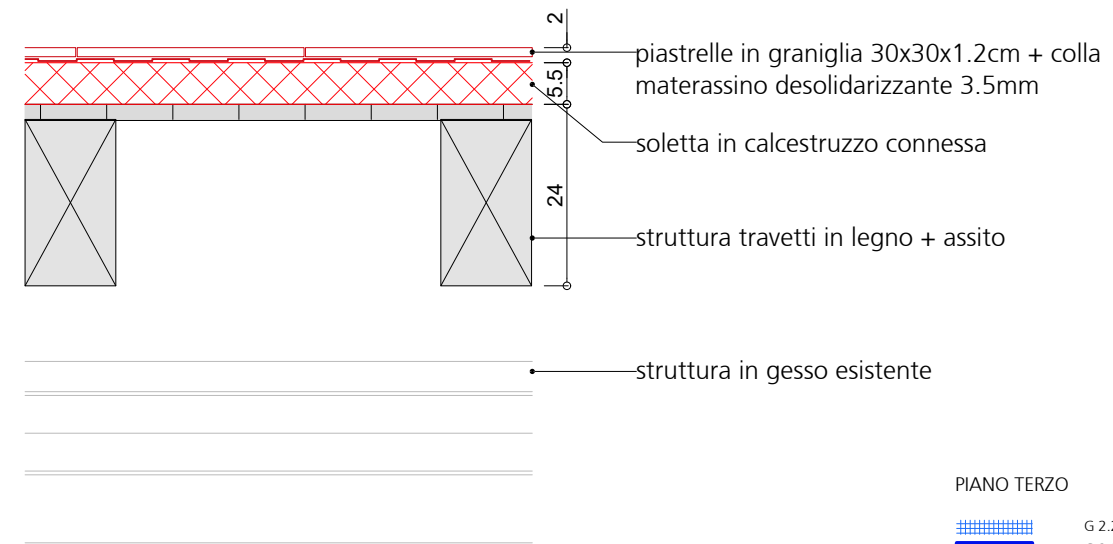

piano secondo



piano terzo







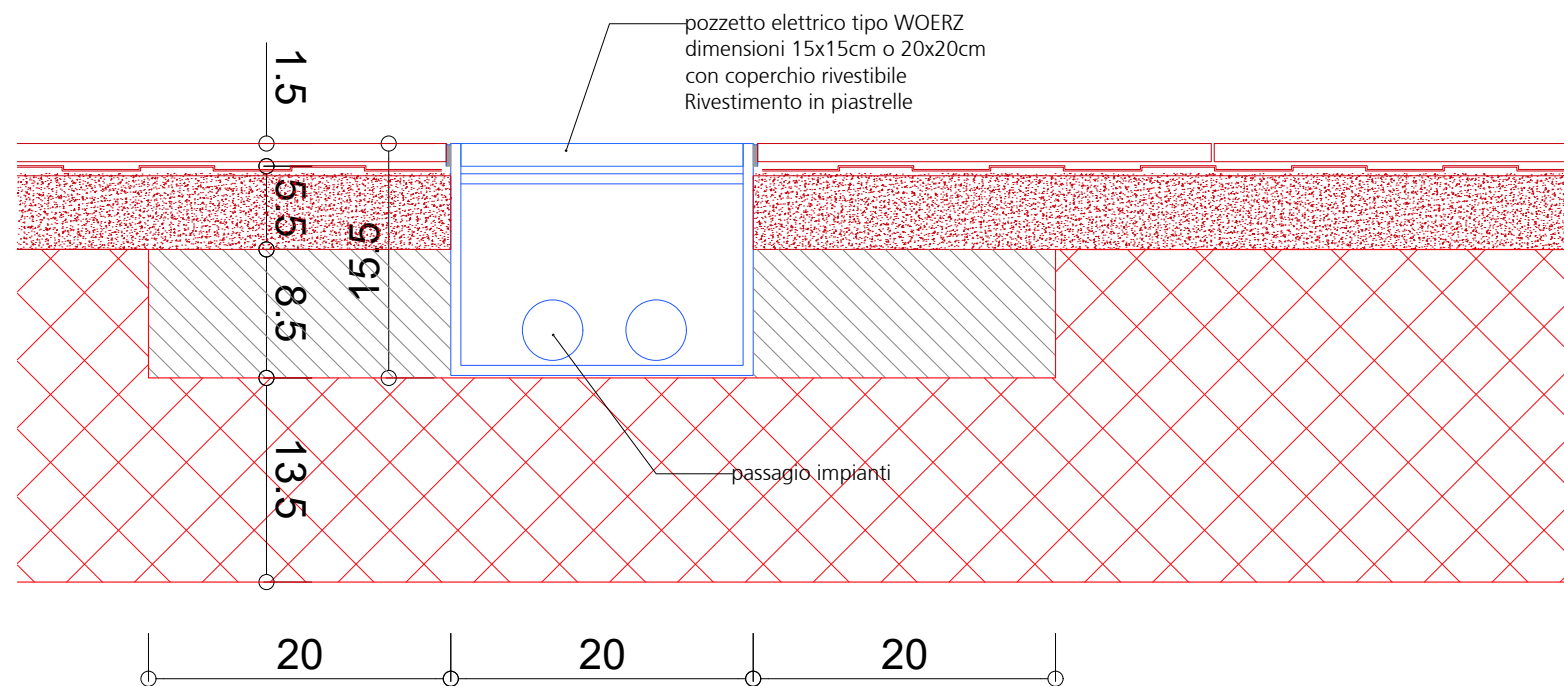
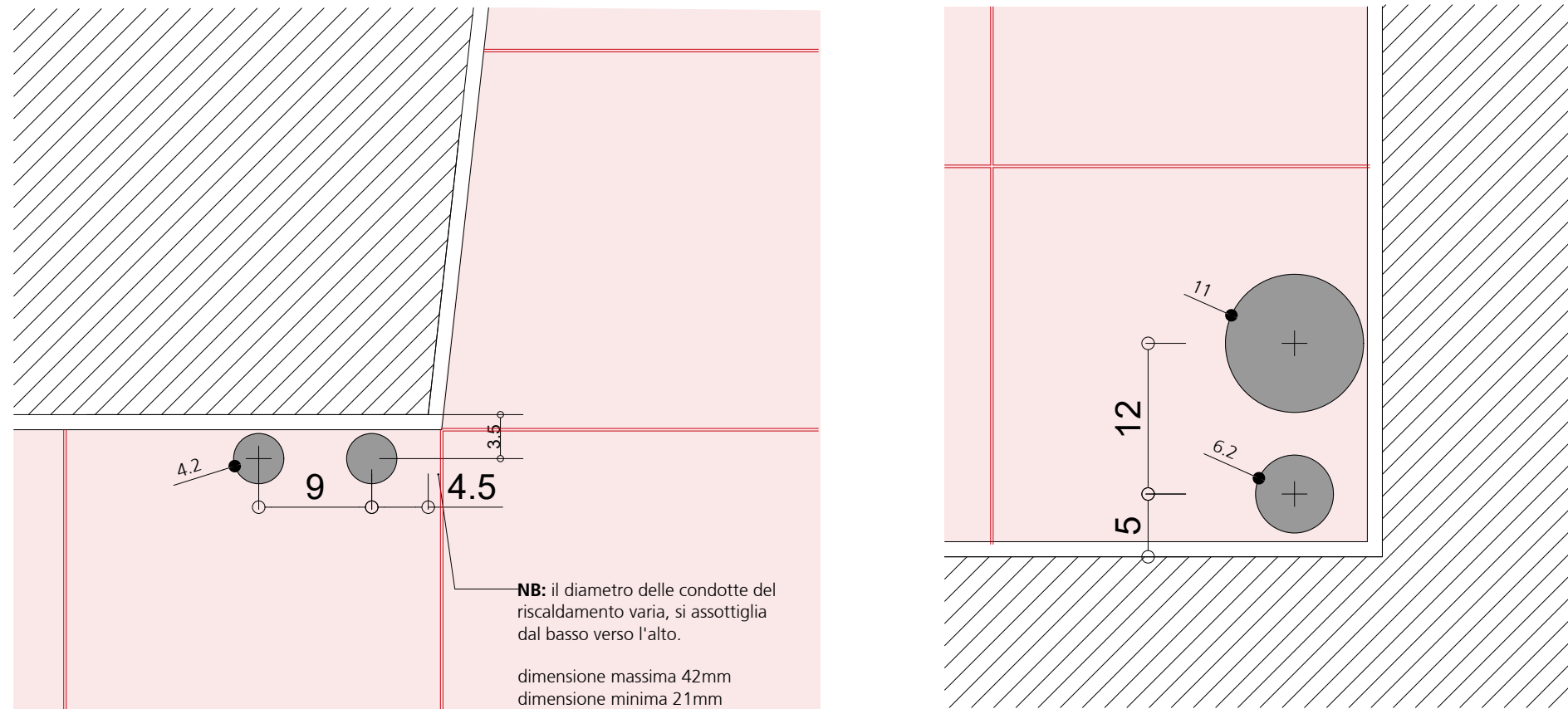

PIANO TERZO

-  G 2.2.1 Pavimenti in piastrelle, 30x30 cm rett., giunti di 2mm
-  G 2.2.10 Battiscopa in piastrelle, 90x15
-  G 2.2.12 Profili in metallo per giunti di movimento
-  G 2.2.12 Profili in metallo
-  tagli in vista
-  tagli in vista curvi





PIANO TERZO

-  G 2.2.1 Pavimenti in piastrelle, 30x30 cm rett., giunti di 2mm
-  G 2.2.10 Battiscopa in piastrelle, 90x15
-  G 2.2.12 Profili in metallo per giunti di movimento
-  G 2.2.12 Profili in metallo
-  tagli in vista
-  tagli in vista curvi



ETHSIAVOTIA	REMO LEUZINGER CLAUDIO VICARI ARCHITETTI	DIS:	RIA
PIAZZA MOLINO NUOVO 19 CH-6900 LUGANO T +41 91 922 82 62 F +41 91 922 89 13 info@remoleuzinger.ch claudiovicari@remoleuzinger.ch www.remoleuzinger.ch	225 PASTLU - RISTRUTTURAZIONE DEGLI SPAZI INTERNI DEL PALAZZO DEGLI STUDI DI LUGANO	DATA:	14.03.2025
	COMMITTENTE: DECS - DIVISIONE DELLA SCUOLA DFE - SEZIONE DELLA LOGISTICA	SCALA:	1:300
		DIM:	42.0 x 29.7
	G 2.2 PAVIMENTI IN PIASTRELLE DI GRANIGLIA	PA	4.7.5.03
	DETTAGLI - TAGLI E INTAGLI		